

CITY OF JOLIET

2024

ROADWAY IMPROVEMENTS Russell St (Clement – Highland)

MFT SEC: 24-00564-00-FP

INDEX OF SHEETS

- 1. COVER SHEET
- 2. SUMMARY OF QUANTITIES
- 3. TYPICAL SECTION SHEET
- 4. PLAN and PROFILE
- 5. CROSS SECTIONS
- 6. GENERAL NOTES
- 7. LEGEND AND DETAILS

JOLIET TOWNSHIP, E 1/2, NW 1/4, SECTION 4

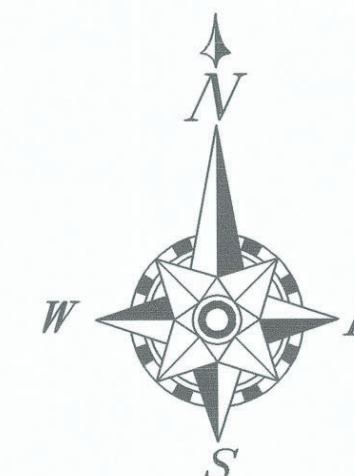
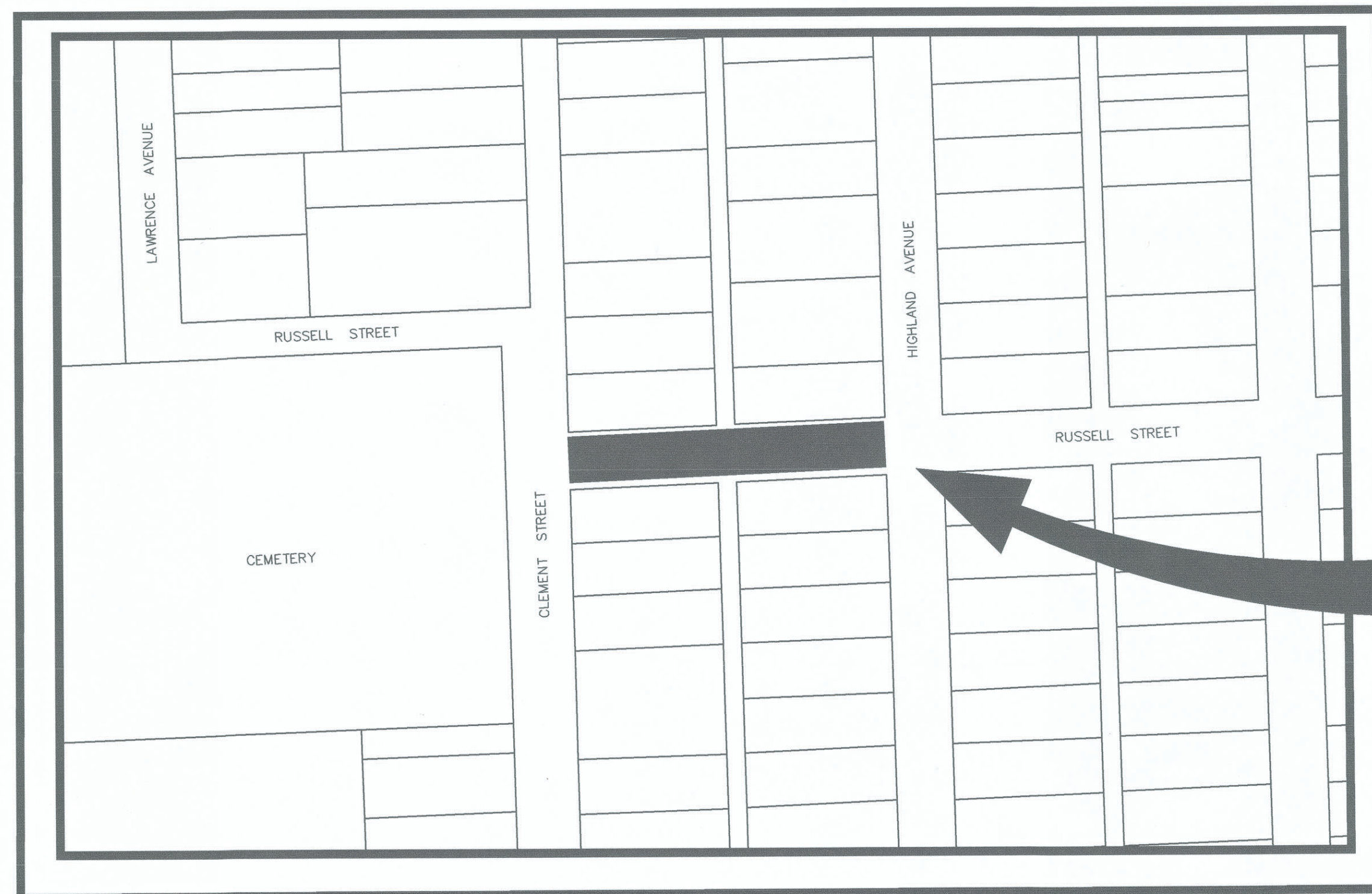

Project Location

DESIGNED & PREPARED BY:

DAVID D ORTIZ

[Signature]
CIVIL ENGINEER

APPROVED BY:

CITY OF JOLIET
DEPARTMENT OF PUBLIC WORKS
SEAN MIKOS, P.E.

[Signature]
DEPUTY DIRECTOR OF PUBLIC WORKS



Date Sealed 3/4/2024

Date Expired 11/30/2025

DATE: 3/5/2024

REVISIONS			
No.	DATE	DESCRIPTION	BY
1	XX-XX-XX	PER XXX	XXX
2	XX-XX-XX	PER XXX	XXX
3	XX-XX-XX	PER XXX	XXX
4	XX-XX-XX	PER XXX	XXX
5	XX-XX-XX	PER XXX	XXX
6	XX-XX-XX	PER XXX	XXX
7	XX-XX-XX	PER XXX	XXX
8	XX-XX-XX	PER XXX	XXX
9	XX-XX-XX	PER XXX	XXX
10	XX-XX-XX	PER XXX	XXX

WARNING !!!



CALL BEFORE YOU DIG
CITY OF JOLIET
UTILITY INFORMATION
724-4200

TRAFFIC DATA
RUSSELL STREET 2023 ADT = 318
SPEED LIMIT = 25 MPH



CITY OF JOLIET
DEPARTMENT OF PUBLIC WORKS
150 W. JEFFERSON STREET
JOLIET, ILLINOIS 60431
(815)-724-4200

SUMMARY OF QUANTITIES

ITEM NO.	ITEM DESCRIPTION	QUANTITIES	UNITS
NO. 1	TREE ROOT SAWING (SPECIAL)	4	EACH
NO. 2	PARKWAY EXCAVATION	730	SQ YD
NO. 3	ROADWAY EXCAVATION	395	CU YD
NO. 4	REMOVAL AND DISPOSAL OF UNSUITABLE MATERIAL	100	CU YD
NO. 5	REMOVAL AND DISPOSAL OF CONTAMINATED MATERIAL	25	CU YD
NO. 6	TRENCH BACKFILL	10	CU YD
NO. 7	SUB-BASE GRANULAR MATERIAL, TYPE C 4"	255	SQ YD
NO. 8	AGGREGATE BASE COURSE, TY B, 8"	1040	SQ YD
NO. 9	HMA SURFACE COURSE, IL 9.5 MIX D N50 1.5"	98	TON
NO. 10	HMA BINDER COURSE, IL 19.0 N50, 2.5"	135	TON
NO. 11	POROUS GRANULAR EMBANKMENT (SPECIAL)	100	CU YD
NO. 12	BITUMINOUS MATERIAL (TACK COAT)	240	LBS
NO. 13	BITUMINOUS MATERIAL (PRIME COAT)	2400	LBS
NO. 14	HMA SURFACE REMOVAL, BUTT JOINT	34	SQ YD
NO. 15	CATCH BASIN, TYPE C, TYPE 11 FRAME & GRATE	2	EACH
NO. 16	FRAME & LID TO BE FURNISHED AND INSTALLED, TY 1 CL	1	EACH
NO. 17	FRAME & GRATE TO BE ADJUSTED	2	EACH
NO. 18	CATCH BASINS TO BE ADJUSTED	2	EACH
NO. 19	MANHOLES TO BE ADJUSTED	2	EACH
NO. 20	COMBINATION CONCRETE CURB & GUTTER, TYPE B-6.12	544	LIN FT
NO. 21	COMBINATION CONCRETE CURB & GUTTER REMOVAL & REPLACEMENT	90	LIN FT
NO. 22	COMB CURB AND GUTTER REMOVAL	40	LIN FT
NO. 23	SIDEWALK REMOVAL	1050	SQ FT
NO. 24	PORTLAND CEMENT CONCRETE DRIVEWAY PAVEMENT, 6"	110	SQ YD
NO. 25	PORTLAND CEMENT CONCRETE DRIVEWAY PAVEMENT, 8"	10	SQ YD
NO. 26	PORTLAND CEMENT CONCRETE SIDEWALK, 5"	1040	SQ FT
NO. 27	HOT MIX ASPHALT DRIVEWAY PAVEMENT, 3"	10	SQ YD
NO. 28	FULL DEPTH PATCH, 10.5"	50	SQ YD
NO. 29	FURNISHING AND PLACING TOPSOIL, 3"	500	SQ YD
NO. 30	SODDING	500	SQ YD
NO. 31	TRAFFIC CONTROL AND PROTECTION	1	L SUM
NO. 32	SAWCUT ASPHALT SURFACE	250	LIN FT
NO. 33	ASPHALT/ CONCRETE SAWING	10	LIN FT
NO. 34	SAWCUT CONCRETE SURFACE	120	LIN FT
NO. 35	PROTECTIVE COAT	400	SQ YD
NO. 36	DETECTABLE WARNING	80	SQ FT
NO. 37	EROSION CONTROL	1	L SUM
NO. 38	HARDWOOD MULCH	4	EACH
NO. 39	DRIVEWAY PAVEMENT REMOVAL	140	SQ YD
NO. 40	BARRIER CURB	20	LIN FT
NO. 41	RCCP SS 12"	50	LIN FT
NO. 42	DIP SS 12"	3	LIN FT
NO. 43	REMOVE STORM SEWER 18"	24	LIN FT
NO. 44	HMA SURFACE REMOVAL, 1.5"	105	SQ YD
NO. 45	LONGITUDINAL JOINT SEALANT	278	FOOT
NO. 46	VALVE BOX TO BE ADJUSTED	2	EACH
NO. 47	MANHOLE TO BE RECONSTRUCTED	2	EACH



CITY OF JOLIET
 DEPARTMENT OF PUBLIC WORKS
 150 W. JEFFERSON STREET, JOLIET, ILLINOIS 60431
 (815)-724-4200

CHECKED BY: <i>GPR</i>	SCALE: <i>NONE</i>	DATE: <i>3/5/24</i>
DESIGNED BY: <i>DDO</i>		SHEET <i>2</i> OF <i>7</i>
DRAWN BY: <i>KLK</i>		

2024 ROADWAY IMPROVEMENTS
 Russell St (Clement – Highland)
 Summary of Quantities

HOT-MIX ASPHALT MIXTURE REQUIREMENTS	
MIXTURE TYPE	AIR VOIDS @ Ndes
FLEXIBLE DEPTH PAVEMENT	
HOT-MIX ASPHALT SURFACE COURSE, MIX "D", N50 (IL-9.5mm); 1½"	4% @ 50 Gyr.
HOT-MIX ASPHALT BINDER COURSE, IL-19.0, N50; 2½"	4% @ 50 Gyr.
DRIVEWAYS	
HOT-MIX ASPHALT SURFACE COURSE, MIX "D", N50 (IL-9.5mm) 1½"	4% @ 50 Gyr.
HOT-MIX ASPHALT BINDER COURSE, IL-19.0, N50; 1½"	4% @ 50 Gyr.
FULL DEPTH PATCH	
HOT-MIX ASPHALT SURFACE COURSE, MIX "D", N50 (IL-9.5MM) 1½"	4% @ 50 Gyr.
HOT-MIX ASPHALT BINDER COURSE, IL-19.0, N50; 1½"	4% @ 50 Gyr.

THE WEIGHT USED TO CALCULATE ALL HMA SURFACE MIXTURE QUANTITIES IS 112 LBS/SQ. YD/IN.

THE "AC TYPE" FOR POLYMERIZED HMA MIXES SHALL BE "SBS/SBR PG70-22" AND FOR NON-POLYMERIZED HMA THE "AC TYPE" SHALL BE "PG 64-22" UNLESS MODIFIED BY DISTRICT ONE SPECIAL PROVISIONS. FOR "PERCENT OF RAP" SEE DISTRICT ONE SPECIAL PROVISIONS.

TRAFFIC DATA
RUSSELL STREET 2023 ADT = 318
SPEED LIMIT = 25 MPH

- (A) HOT-MIX ASPHALT, SURFACE COURSE, IL-9.5, MIX "D" N50, 1.5"
- (B) HOT-MIX ASPHALT, BINDER COURSE, IL-19.0, N50, 2.5"
- (C) COMBINATION CONCRETE CURB & GUTTER, TYPE B-6.12
- (D) AGGREGATE BASE COURSE TYPE B, 8"CA-06
- (E) PORTLAND CEMENT CONCRETE SIDEWALK, 5"THICK W/ 10x10 WELDED WIRE FABRIC (W.W.F.) ON 4"AGGREGATE BASE, TYPE C (6"THICK @ RESIDENTIAL DRIVEWAY W/ 4"BASE)
- (F) BITUMINOUS MATERIAL (TACK COAT)
- (G) BITUMINOUS MATERIAL (PRIME COAT)
- (H) LONGITUDINAL JOINT SEALANT

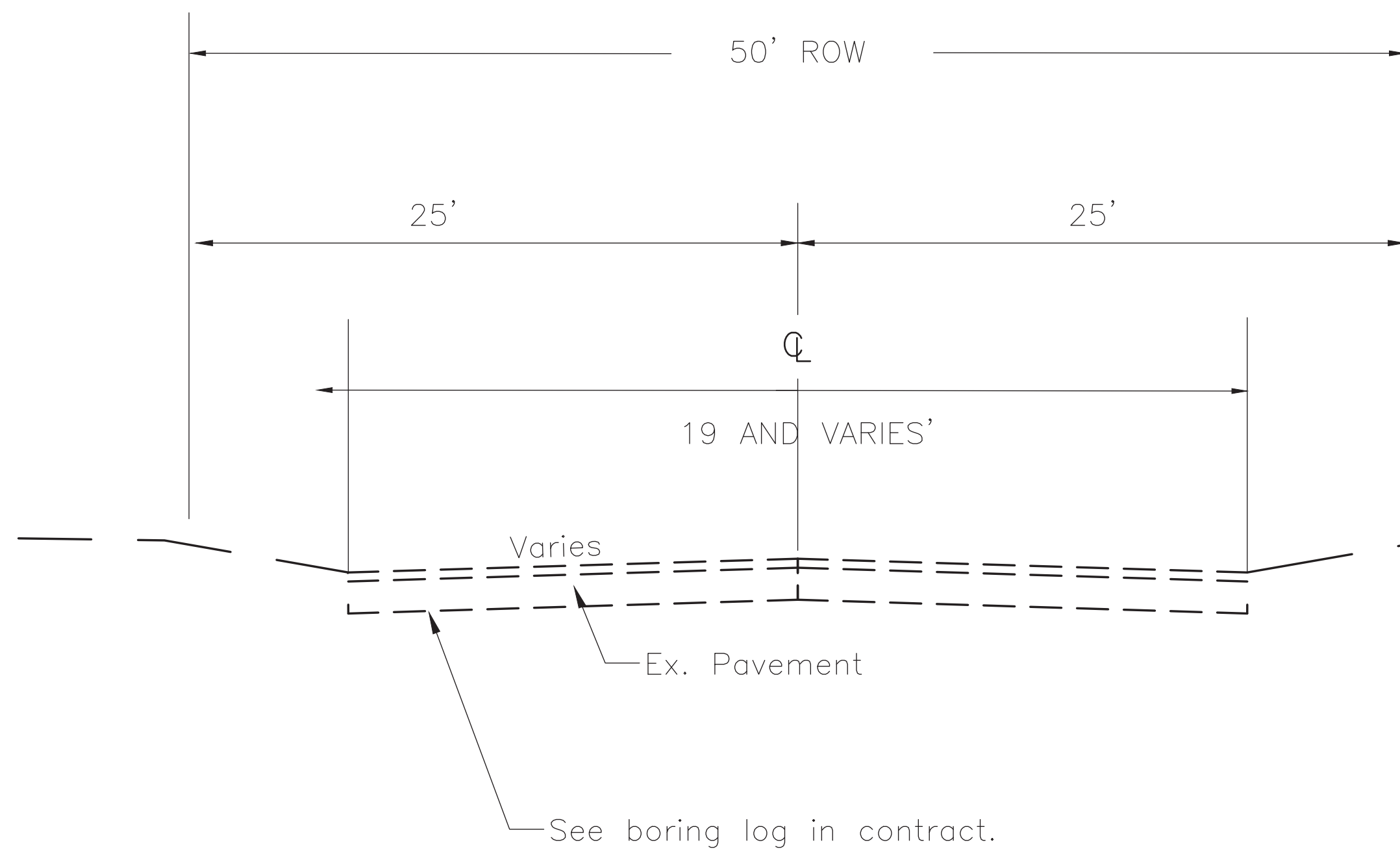

EXISTING SECTION
RUSSELL STREET

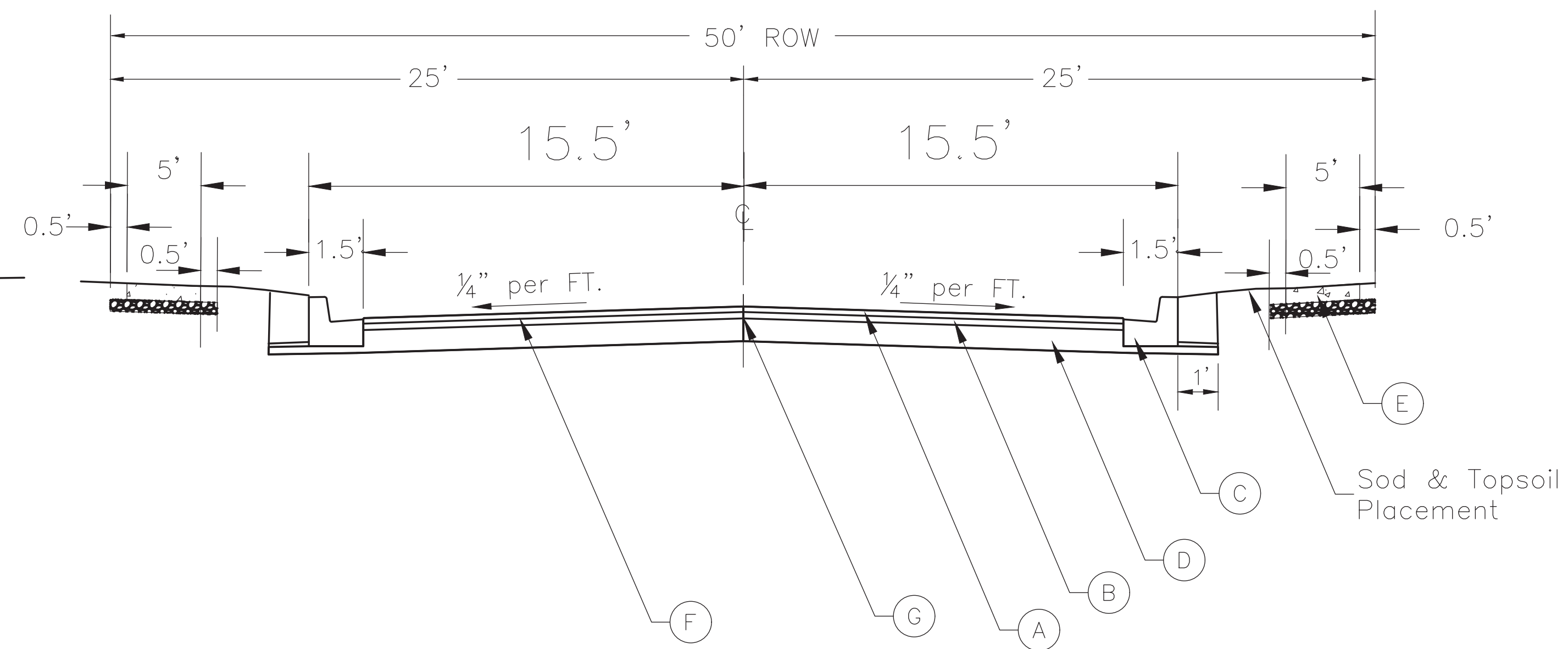

PROPOSED TYPICAL SECTION
RUSSELL STREET

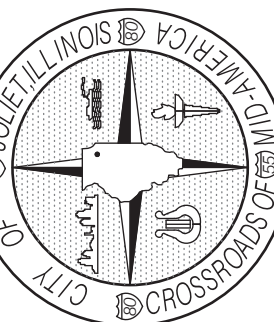

BENCHMARKS:
 BM 1: NW BOLT ON FIRE HYDRANT AT NE CORNER OF RUSSELL & CLEMENT ELEVATION 658.99
 BM 2: SET CROSS IN TOP OF CURB AT THE SE CORNER OF RUSSELL & HIGHLAND ELEVATION 655.63

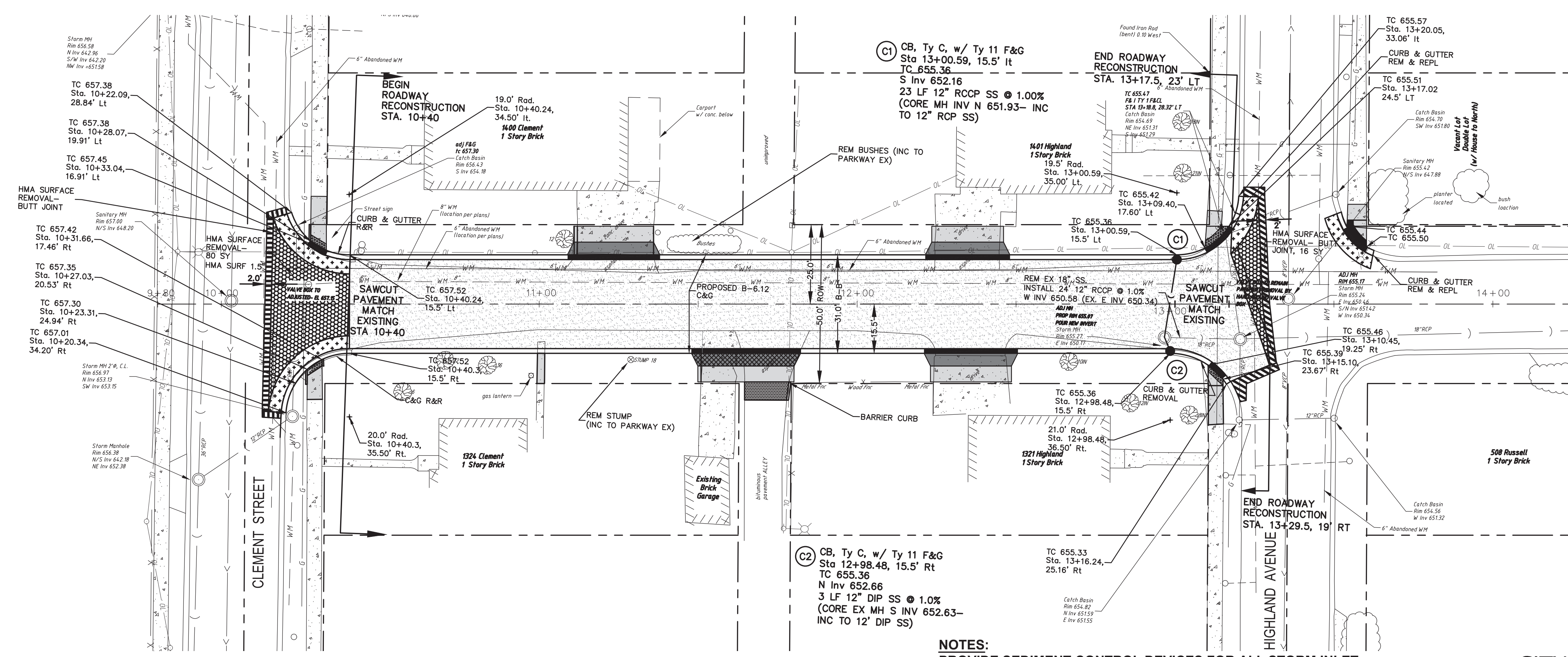
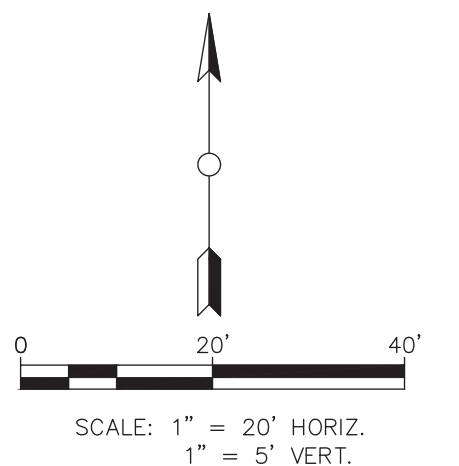

- LEGEND**
- PCC Sidewalk
 - PCC Driveway, 6"
 - PCC Driveway, 8"
 - ROADWAY PAVEMENT RECONSTRUCTION
 - Hot Mix Asphalt Driveway Pavement, 3"
 - FULL DEPTH PATCH, 10.5" (1.5" SURFACE -PAID SEPARATELY; 2.5" BINDER, 8" AGG BASE COURSE)
 - HMA SURFACE REMOVAL

NOTES:
 PROVIDE SEDIMENT CONTROL DEVICES FOR ALL STORM INLET STRUCTURES WITHIN OR ADJACENT TO PROJECT LIMITS

CITY OF JOLIET
 ENG: DDO
 DATE: 10/31/2023
 RUSSELL STREET

RUSSELL PROFILE

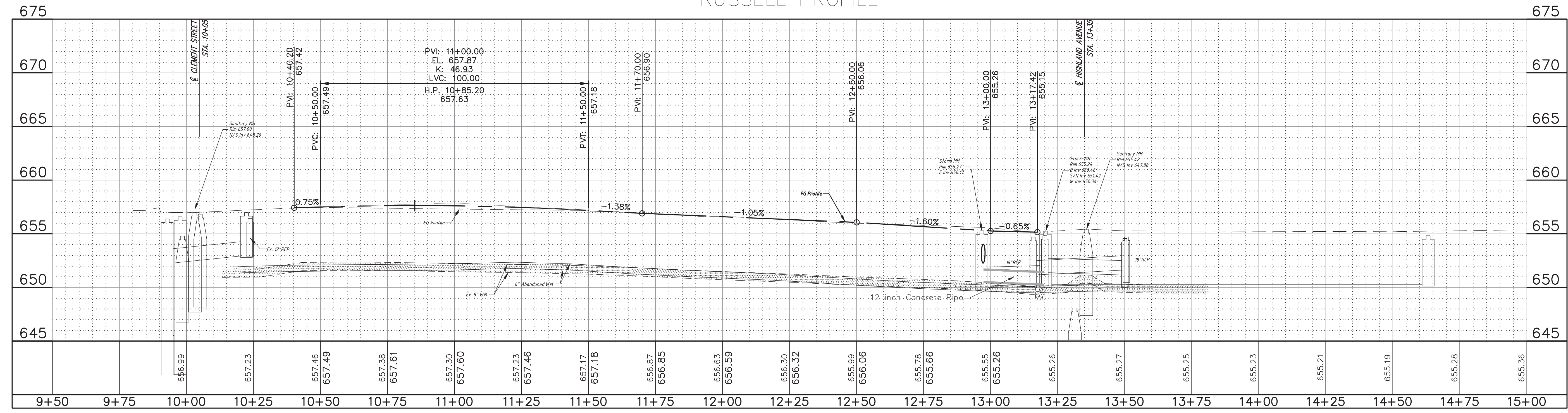

U:\Public Works\Projects\2024 Projects\Russell St (Clement - Highland)\Draws\Russell Eng.dwg Plot Date: 3/5/2024 1:34 PM

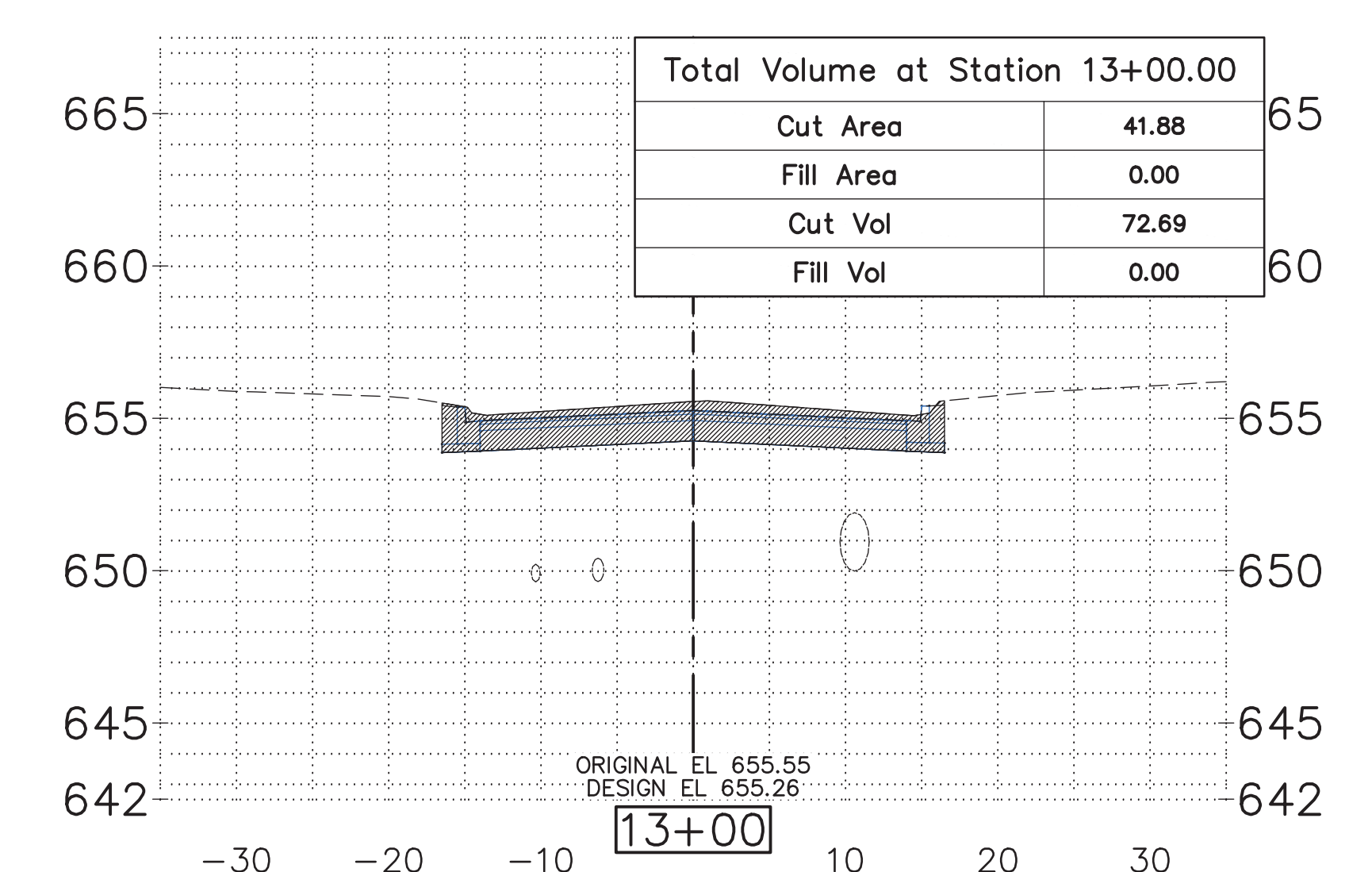
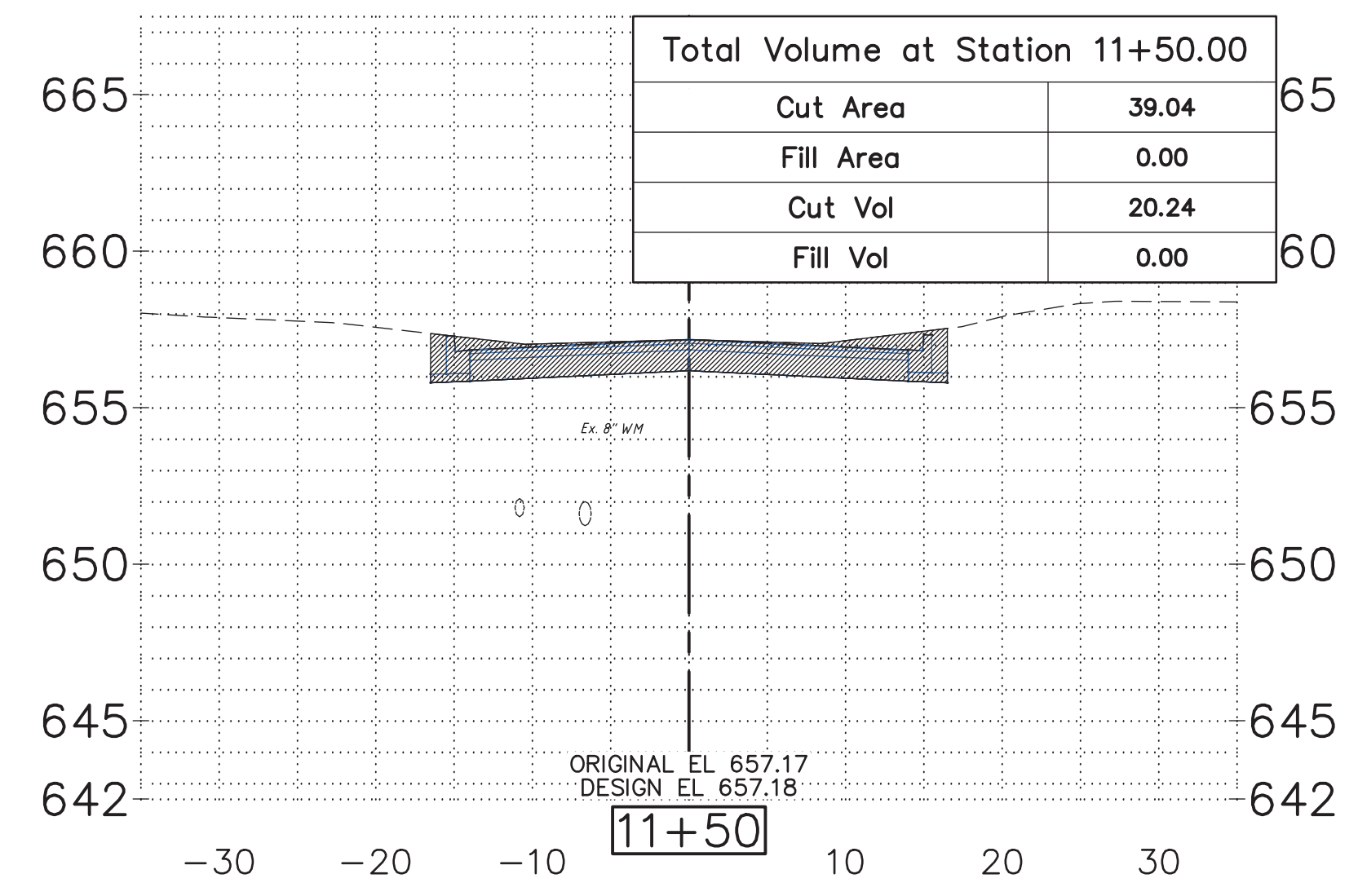
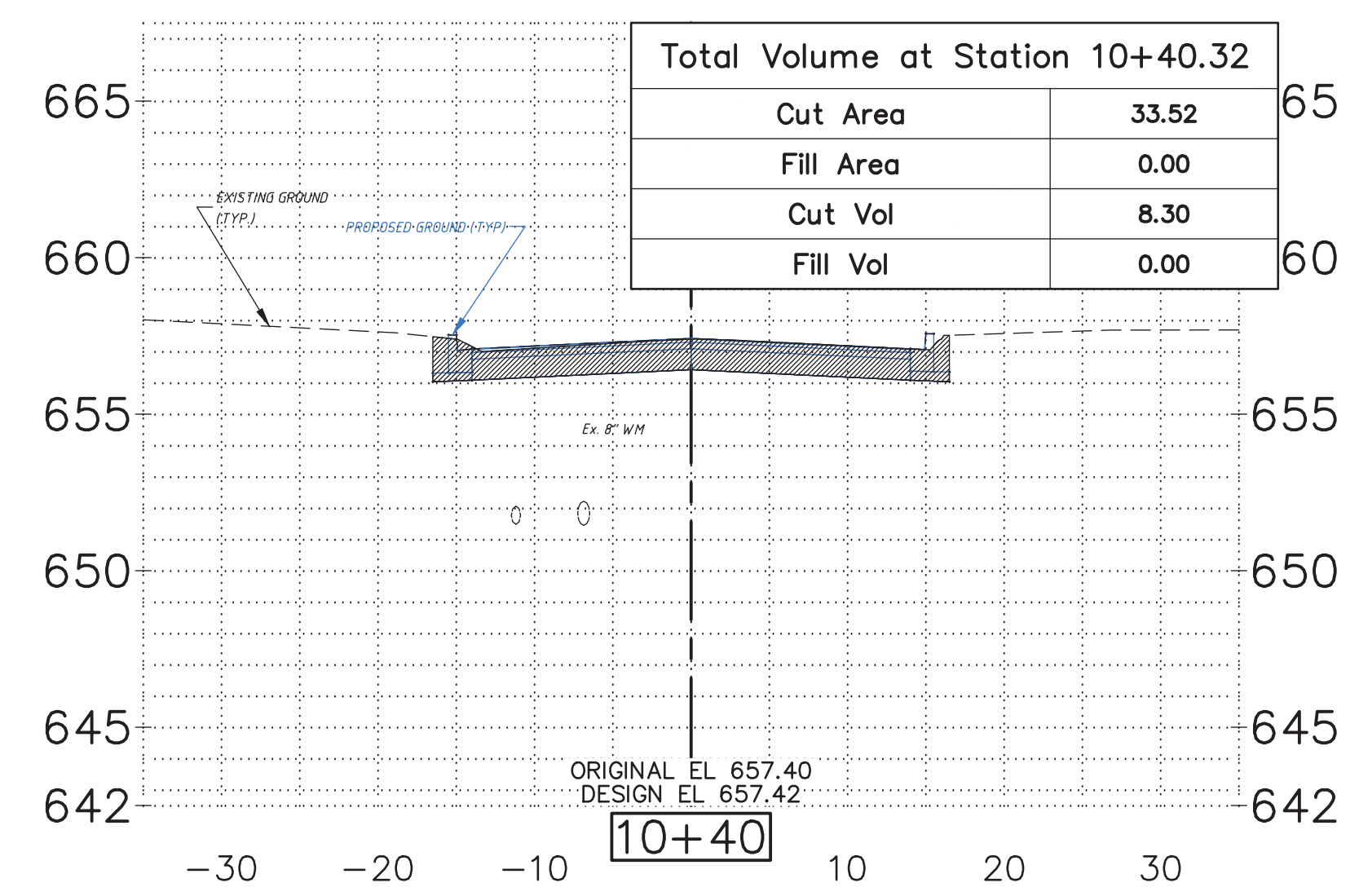
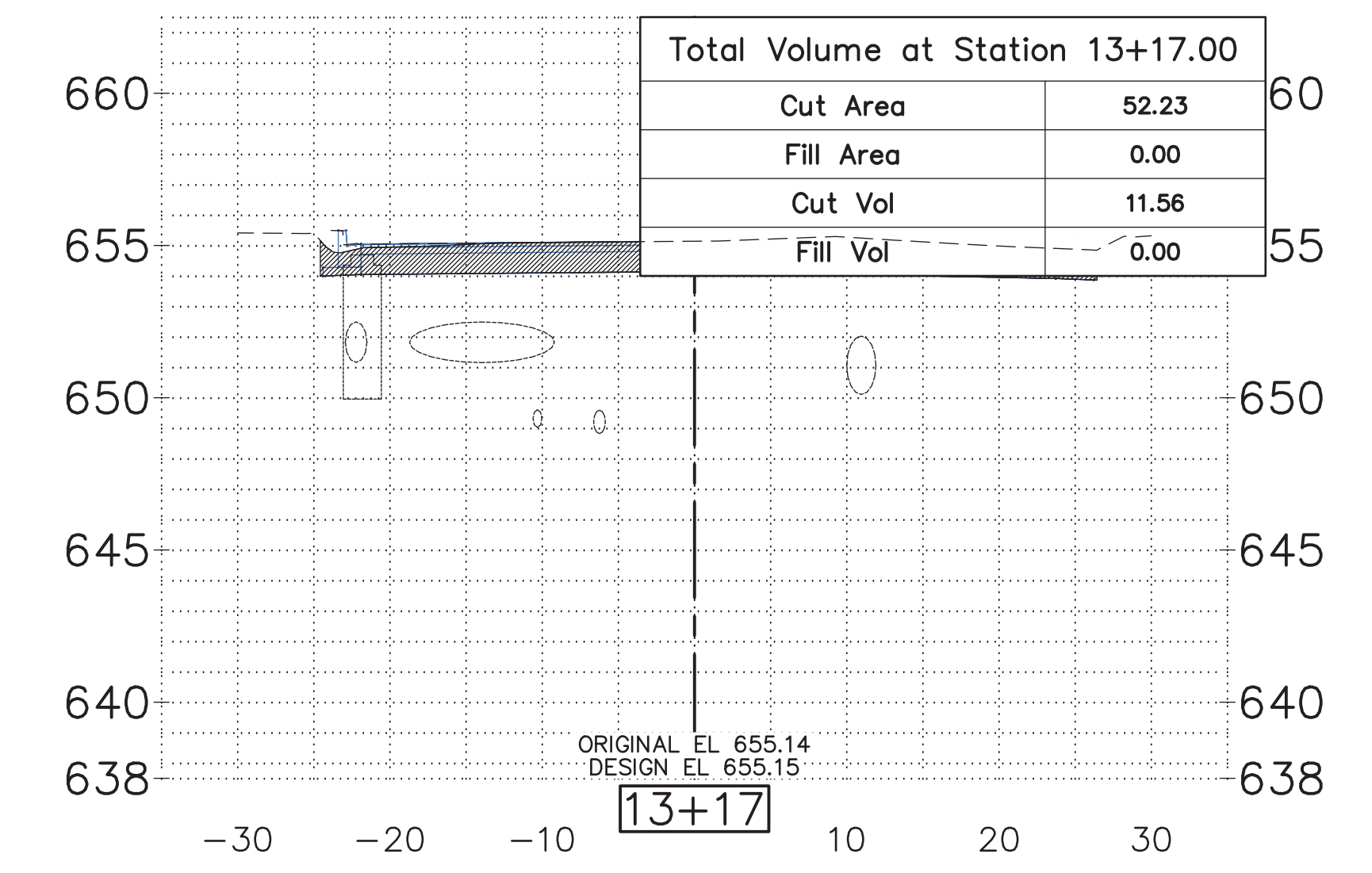
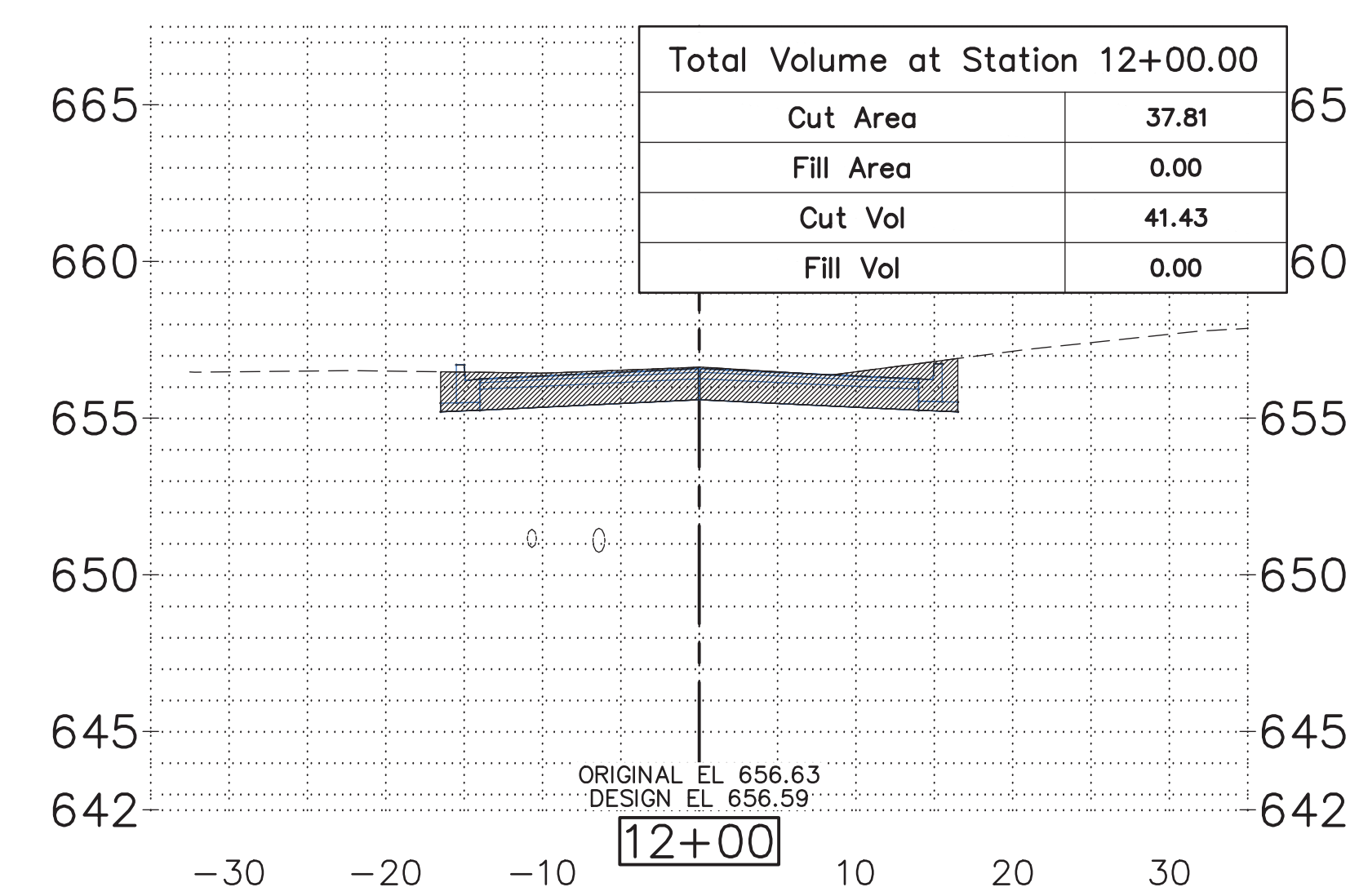
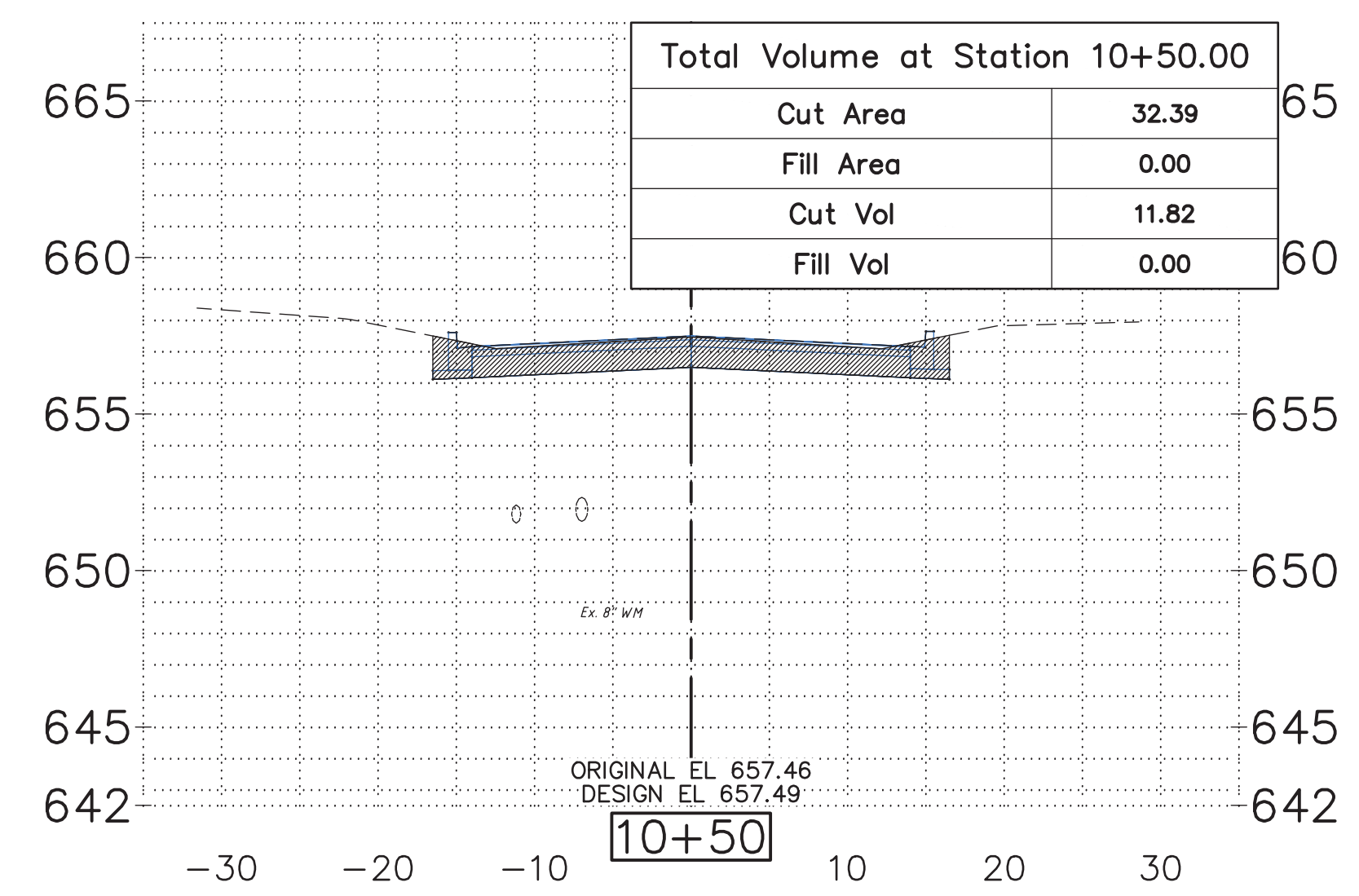
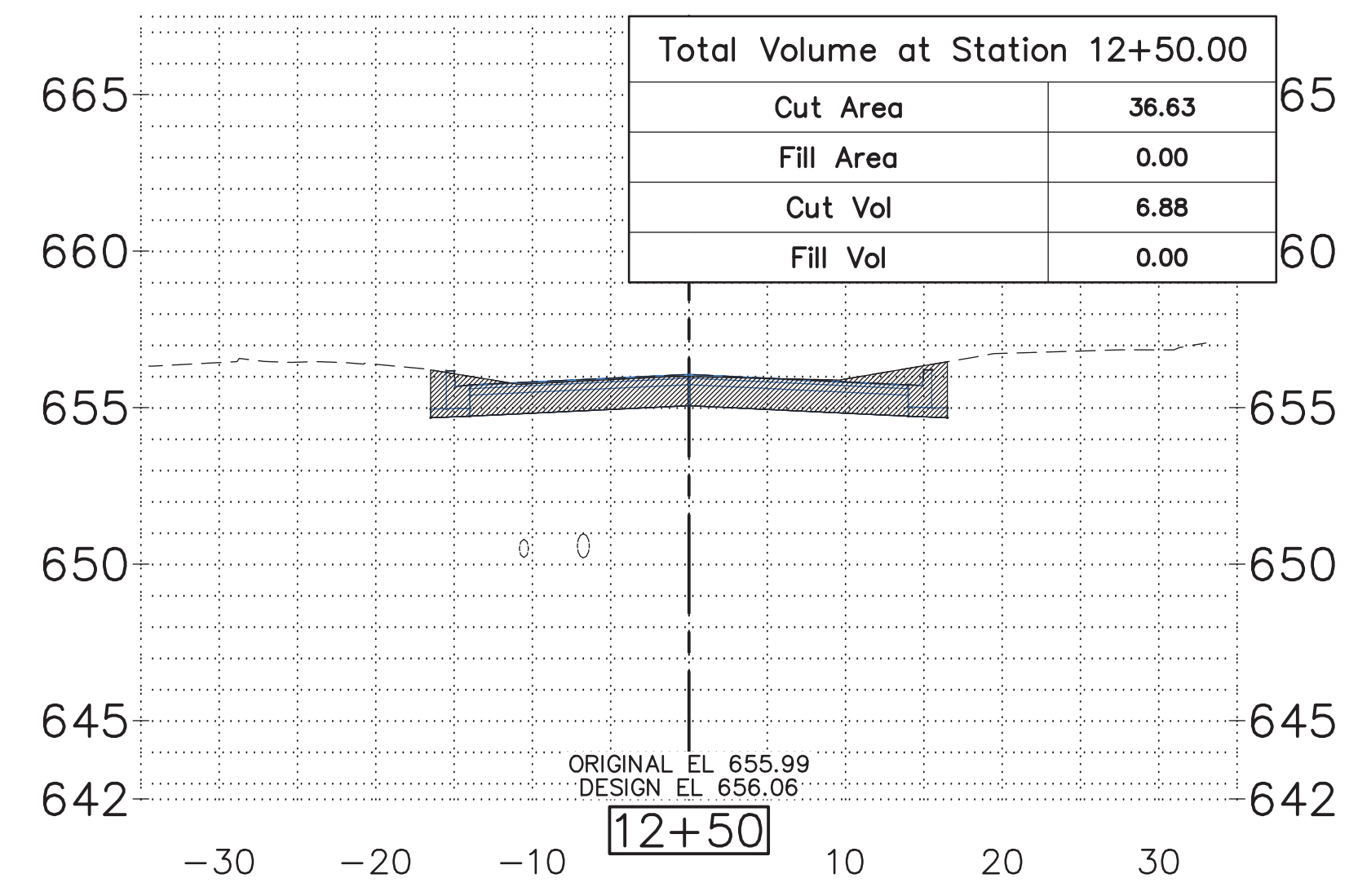
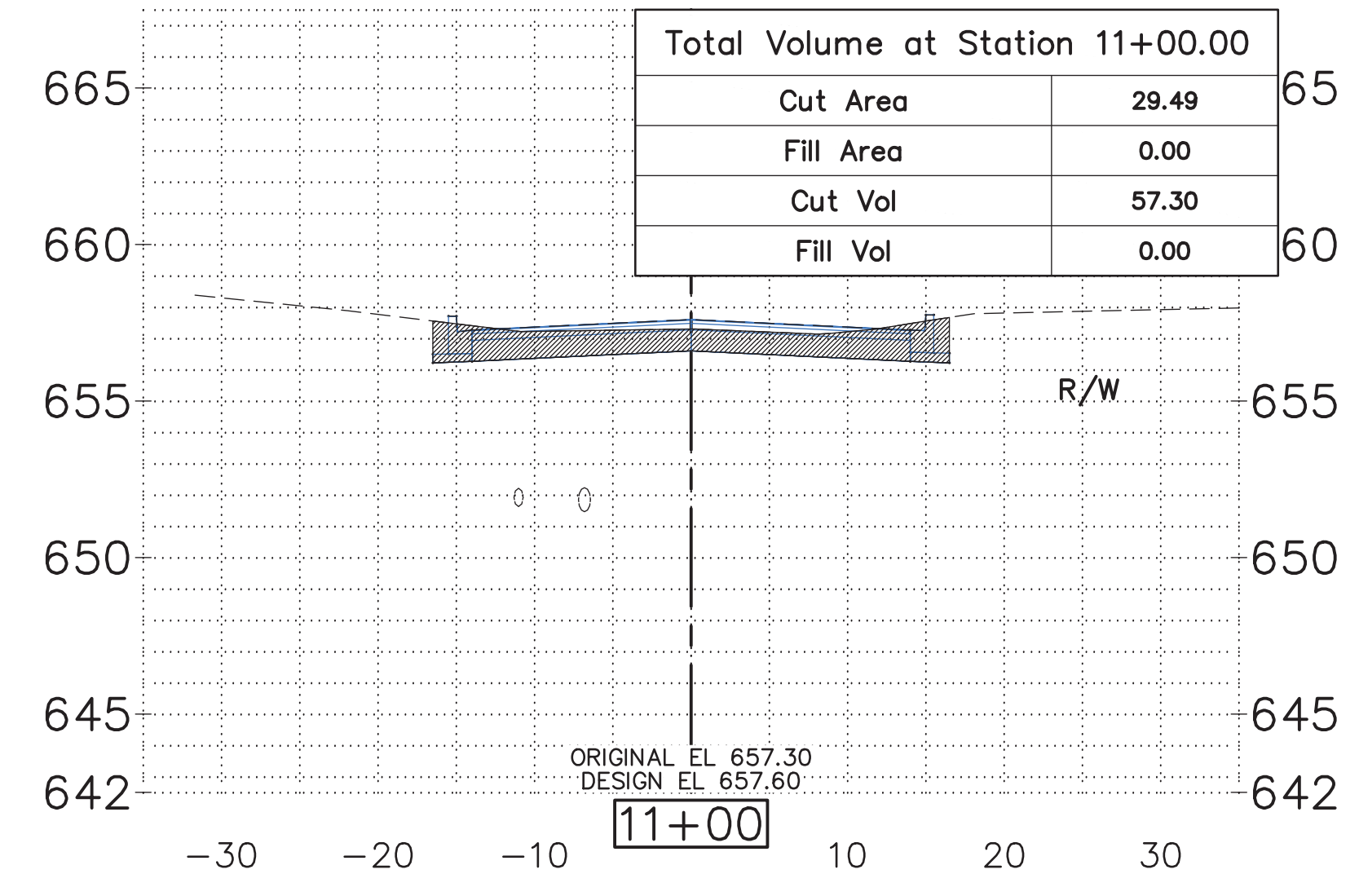

U:\Public Works\CAD\Projects\2024\Projects\Russell St (Clement - Highway)\Highway\Russell Engineering Plot Date: 3/5/2024 1:34 PM

GENERAL NOTES

- The cost of any labor or materials necessary in connecting existing drain tiles or storm sewer to proposed drainage structures, or in connecting proposed storm sewers to existing drainage structures shall be considered incidental to the proposed drainage structures or storm sewers.
- The location of underground utilities on the plans represents the best knowledge of the City and the indicated adjustments or reconstructions are considered to be reasonably accurate. It shall be the Contractor's responsibility, as detailed in Section 107.39 of the Standard Specifications, to verify locations of underground utilities before starting construction operations. The Contractor shall indemnify the City, its Officers, and employees against all claims due to damage to corporate or private property resulting from his construction operations as described in Articles 107.20 and 107.26 of the Standard Specifications. The Contractor shall make his own investigation to determine the existence, nature and location of all utility lines and appurtenances within the limits of improvements. The Contractor will be responsible for performing exploratory excavation to expose any underground utility - including services - with a City representative present and identifying all possible utility conflicts within the proposed public improvement prior to excavating for the roadway. The Contractor shall backfill these exploratory excavation sites with trench backfill and shall maintain the roadway until all the identified utility conflicts are resolved. The cost of the exploratory excavation for underground utilities shall be considered incidental to the contract. No other compensation shall be allowed for this work. The Contractor will be required to cooperate with all Contractors, Utility companies, and the City of Joliet, involved with the removal, temporary relocation, reconstruction, or abandonment by these agencies of any and all services or facilities owned or operated by them within the limits of the improvement. Before doing any work which will damage, disturb, or leave unsupported or unprotected any utility lines encountered, the Contractor shall notify the respective owner thereof, who will make arrangements for relocating, adjusting, or otherwise maintaining or abandoning services or lines that fall within the limits of the proposed construction without cost to the Contractor, including the removal of cables, manhole covers, and other appurtenances which the owner desires to salvage. After such arrangements have been made, the Contractor will proceed with the work as directed by the Engineer. No extra compensation will be allowed the Contractor for any expenses incurred by complying with these requirements, or because of delays, inconvenience, or interruptions in his work resulting from the failure of any City or Utility Company to remove, relocate, reconstruct, or abandon their services when required by the Contractor's operations. An extension of time may be granted to the extent the Contractor's operations were affected. The Contractor shall be responsible for coordinating his work with that of these agencies as to ensure that this improvement is not delayed because of necessary changes in the existing utilities, public or private.

The Contractor shall take whatever precautions which may be necessary to protect the property of various utilities which may be located underground or above ground, at or adjacent to the site of this improvement. The contractor will be required to repair or replace at his own expense or bear the cost of having the utility repair or replace any public/private utility which has been damaged through his efforts. The procedure and specifications of repair will be in accordance with the regulations and/or policy of the utility. The Utility shall be given notice by the Contractor to locate and identify all their installations at the site of this improvement so that this improvement is not delayed because of necessary changes in the existing utilities, public or private.
- The Contractor shall proceed with caution for any excavation and preparation of the trench so that the exact location of underground structures may be determined. Prior to proceeding with any excavation, the contractor shall contact all utility companies in the area to aid in locating their underground services.

The Contractor shall contact the involved utility companies not less than 48 hours prior to beginning construction. The majority of these utilities may be contacted through J.U.L.I.E. at (800) 892-0123. In addition, the Contractor shall be responsible to contact the City of Joliet Utilities 48 hours prior to beginning the construction at (815)724-4220. It shall remain the Contractor's responsibility to contact all utilities.

The Contractor shall take all reasonable precautions against damage to existing utilities. However, in the event of a break in an existing watermain, gas main, sewer, or underground cable, he shall immediately notify the responsible official of the organization operating the utility interrupted. The Contractor shall lend all possible assistance in restoring services and shall assume all cost, charges, and claims connected with the interruption and repair of such services.

Privately owned utilities requiring adjustment will be adjusted by the utility company involved. No additional compensation will be allowed for any delays or inconveniences caused the Contractor due to said adjustments.
- Trench backfill must be provided under all structural elements including roadway surfaces, driveways, sidewalks, etc. and as directed by the Engineer.
- Existing sidewalk, pavement, driveway pavement and curb and gutter damage due to the Contractor's operations shall be replaced at the expense of the Contractor.
- For all manholes, catch basins, and inlets, the distance shown on

- the plans is from the baseline to the center of the structure, except structures in the curb line where the distance is shown to the back of curb.
- All existing valve vaults and manholes indicated on the plans or as directed by the Engineer shall be covered with a Contractor-supplied steel plate at all times during construction. Upon preparation for binder course, the frame shall be installed to the surface elevation as shown on the plans or as directed by the Engineer and set in concrete according to the Standard Specifications.
- This project is to be built according to the City of Joliet Special Provisions and General Conditions latest revision unless otherwise stated in the contract documents.
- Where section or sub-section monuments are encountered, the Engineer shall be notified before such monuments are removed. The Contractor shall protect and carefully preserve all property markers and monuments until the owner and an authorized surveyor or agent has witnessed or otherwise referenced their location. However, if damaged irons occur, it is the responsibility of the Contractor to restore the marker per Registered Land Surveyor at his own expense.
- It shall be the responsibility of the Contractor to construct each inlet or catch basin at the proper location so that the frame or grate matches the curb line as shown in the applicable Standard.
- All proposed manholes, catch basins and inlets shall be fabricated to include no less than four (4) inches of adjusting rings to meet the required grade.
- The cost of the removal and disposal of the asphalt shall be considered incidental to roadway excavation.
- All structure rim elevations located in the curb line are top of curb elevations unless otherwise noted.
- All grassed areas disturbed during construction operations shall be seeded or sodded in accordance with Sections 642 and 644 of the Standard Specifications, as indicated in the plans.
- Quantities for adjusting sanitary sewer services and water service lines have been added to the summary of quantities and the contract to provide a unit price bid for the item and are to be used only if field conditions require their use, as approved by Engineer.
- The Contractor shall protect existing or new utilities by methods approved by the Engineer and shall brace and support the utilities properly to prevent settlement, displacement, or damage to the utilities. The protection of the utilities as specified herein, will not be paid for separately, but shall be considered incidental to the contract.
- Existing street signs, markers stop signs, and all other roadway signs shall be removed and replaced by the Contractor as per current MUTCD standards and as directed by the Engineer. This work is considered included in the contract and will not be paid for directly. Signs and posts damaged by the contractor shall be replaced by him at his own expense.
- Sidewalk ramps for the handicapped shall be constructed at locations where existing or proposed sidewalks abut the street returns within the limits of this improvement in accordance with Standard Specifications. This work will not be paid for separately but shall be considered incidental to the proposed sidewalk.
- Timeliness of work: The contractor shall perform all work in a timely, orderly, and diligent manner. The Contractor shall cooperate with and conform to the request of the City to expedite particular portions of the work insofar as to complete certain phases of work in a timely manner. Work shall be completed within the timeframe as outlined in the PROPOSAL DOCUMENTS. Contractor shall submit a PROJECT SCHEDULE showing coordination of sub-contractors and sequencing of work. Construction of the concrete curb & gutter shall begin within five (5) working days of the completion of the roadway grading and subbase preparation. Upon completion of the concrete curb & gutter, construction of the driveway aprons shall begin, and remain continuous, such that driveways shall not remain inaccessible for more than 20 calendar days, as measured from the date of completion of roadway excavation. If the contractor cannot meet these requirements, he shall provide temporary stone access to all affected driveways. No additional compensation will be allowed for providing, placing, and removing all temporary access stone.
- Protection of property and surface structures: Trees, shrubbery fences, poles, right-of-way pins and all other property and surface structures shall be protected during construction operations unless the Engineer authorizes their removal for purposes of construction. Any fences, poles, or other manmade surface improvements, which are moved or disturbed by the Contractor shall be restored to the original conditions, after construction is completed, at the Contractor's expense. Any trees, shrubbery, or other vegetation, which are approved for removal by the Engineer in order to facilitate construction operations, shall be removed completely, including stumps and roots, by the Contractor. Responsibility for any damage or claims for damage caused by construction operations to shrubbery or other landscape improvements, which were not authorized for removal by the Engineer, shall be assumed by the Contractor.

- Work to be Done by Others: The City of Joliet Public Works and Utilities, Com-Ed, NICOR, AT&T, and others may be adjusting their facilities during construction of this section. In such event, it will be necessary for the Contractor to cooperate with the various organizations and the City while they are doing this work. All street lighting/utility poles and luminaries required to be moved shall be relocated and wired by the owner of the pole as per their franchise agreement. No compensation shall be allowed to the Contractor for street lighting/utility pole relocation work.
- In accordance with Article 105.09 of the "Standard Specifications", the Contractor shall furnish to the City of Joliet Public Works Office, 150 W. Jefferson Street, at his/her expense, construction layout stakes for the project. The material for all layout stakes and lathe shall be oak. Layout stakes (hubs) shall be 2"x2"x15". Lathe shall be four (4") feet in length. Hubs shall be provided at a rate of one bundle per 300 linear feet of project length for curb and gutter construction and at a rate of one bundle per 600 linear feet of project length for all other construction projects. Lathe shall be provided at a rate of one bundle per 600 linear feet of project length for all construction. The cost incurred by the Contractor in complying with this requirement shall be considered incidental to the contract.
- All lot irons damaged or removed during construction shall be replaced by the contractor and said cost of replacement shall be included in the cost of the contract.
- All public improvement projects shall be submitted under different permit cover for review and approval.
- Installation of or provisions for the installation of all underground utilities (including service laterals) to be placed under pavement areas shall be established prior to the construction of the pavement. The City reserves the right to require trenchless construction for crossing of existing streets.
- Wherever proprietary equipment or material is specified, all proposals for substitution shall be submitted in writing to the Director of Public Works and shall be subject to the findings of the Director.
- Whenever a trench opening encroaches within five (5') feet of a street, sidewalk, driveway, and all other structural appurtenances, trench backfill shall be utilized in the form of CA-06.
- Trench backfill shall be tested in accordance with the Standard Specifications for Road and Bridge Construction in Illinois. Testing frequency shall be one test per trench or one test per 100 linear feet of trench, whichever is greater.
- The Contractor shall, at the Contractor own expense, provide a detailed video log of the existing site conditions prior to construction. The Contractor shall provide such video log in an acceptable format to the City of Joliet. If the Contractor chooses not to complete the video log prior to construction, the Contractor shall be responsible for all property owner complaints that arise at the completion of construction. all repairs from such complaints shall be at the Contractors expense.
- Removal and replacement of mailboxes shall be in accordance with Section 107 of the Standard Specifications and shall be included in the cost of the contract.
- Failure to complete work on time shall be in accordance with Section 108 of the Standard Specifications.

2024 ROADWAY IMPROVEMENTS
Russell St (Clement - Highland)
GENERAL NOTES

CHECKED BY: GPR	SCALE: NONE
DESIGNED BY: DDO	DATE: 3/5/2024
DRAWN BY: KZA	SHEET 6 OF 7

CITY OF JOLIET
DEPARTMENT OF PUBLIC WORKS
150 W. JEFFERSON STREET, JOLIET, ILLINOIS 60431
(815)-724-4200



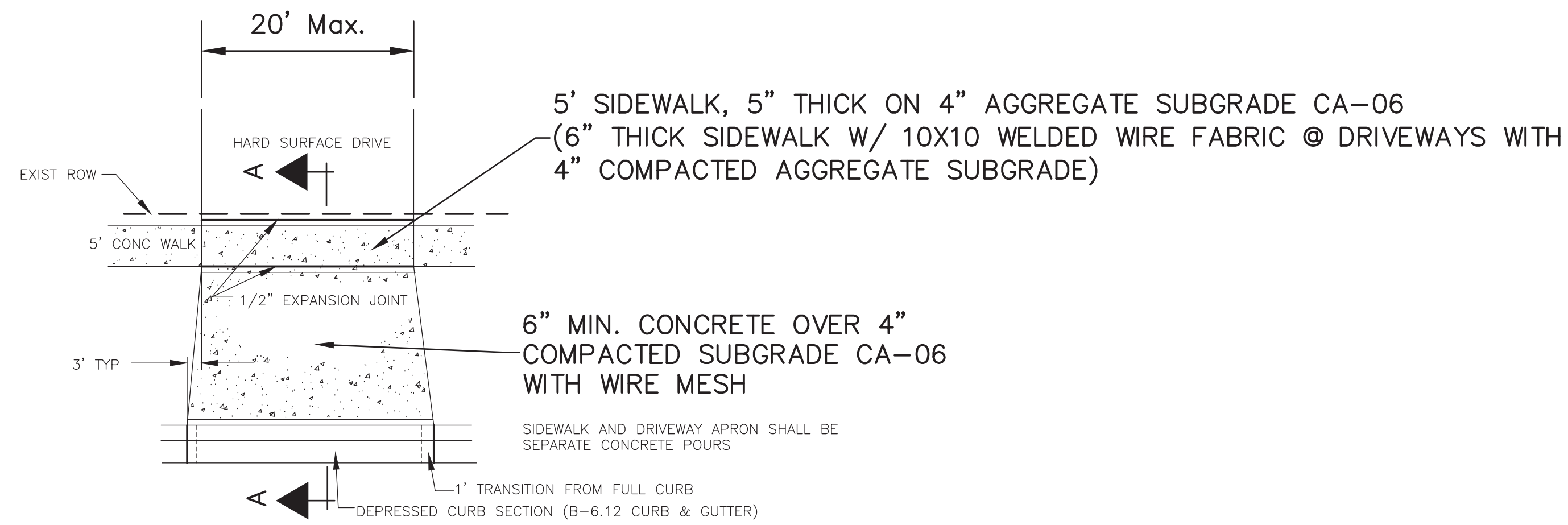

P.C.C. DRIVEWAY APPROACH PLAN

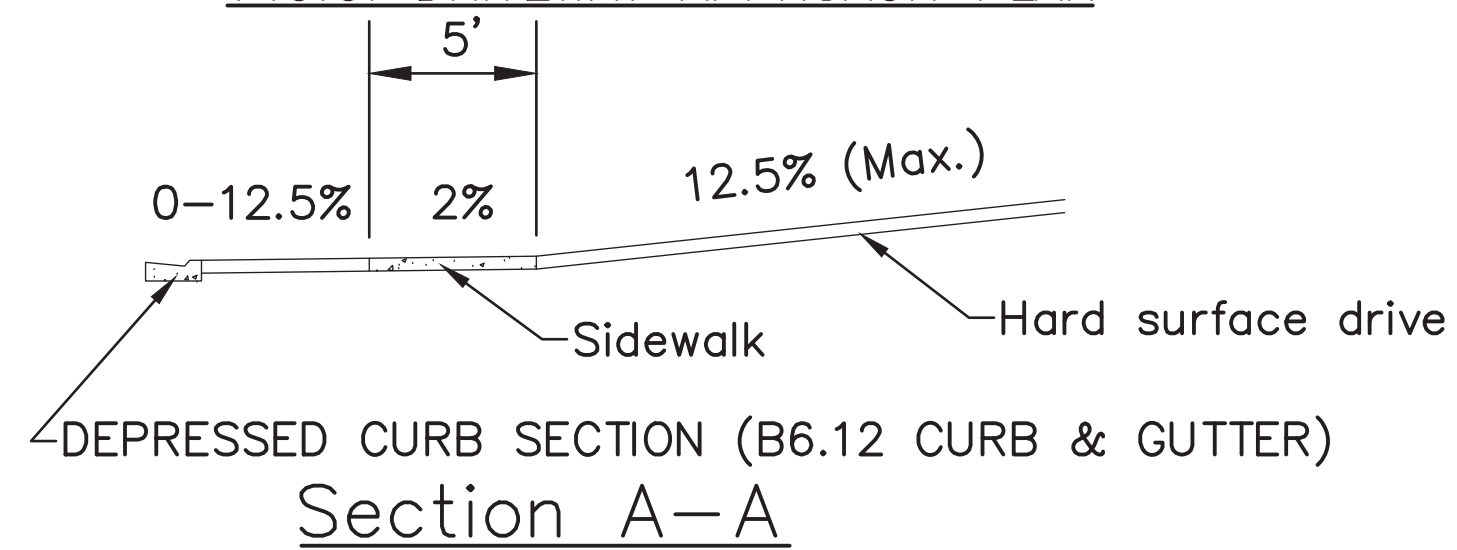

TYPICAL RESIDENTIAL PRIVATE DRIVE

Not to scale.

1. The maximum algebraic difference in grades for any 10 foot interval shall not exceed 10.5% crests, nor 14.5% for sags.
2. Frontage of lots shall drain to adjacent streets except with the prior approval of the Director of Public Works.
3. Concrete drives require control joints at a maximum of every 10 feet each way.
4. A maximum width at the ROW for driveways shall not exceed 20 feet.
5. Asphalt path transitions within the public right-of-way at commercial drives, private drives or approaches shall be accomplished with a 6' minimum length of concrete sidewalk transition (Increase length of concrete sidewalk transition as required to meet the 1:12 (8.33%) maximum slope requirement) so that the asphalt path meets the concrete sidewalk transition at a neat line perpendicular to the path alignment.

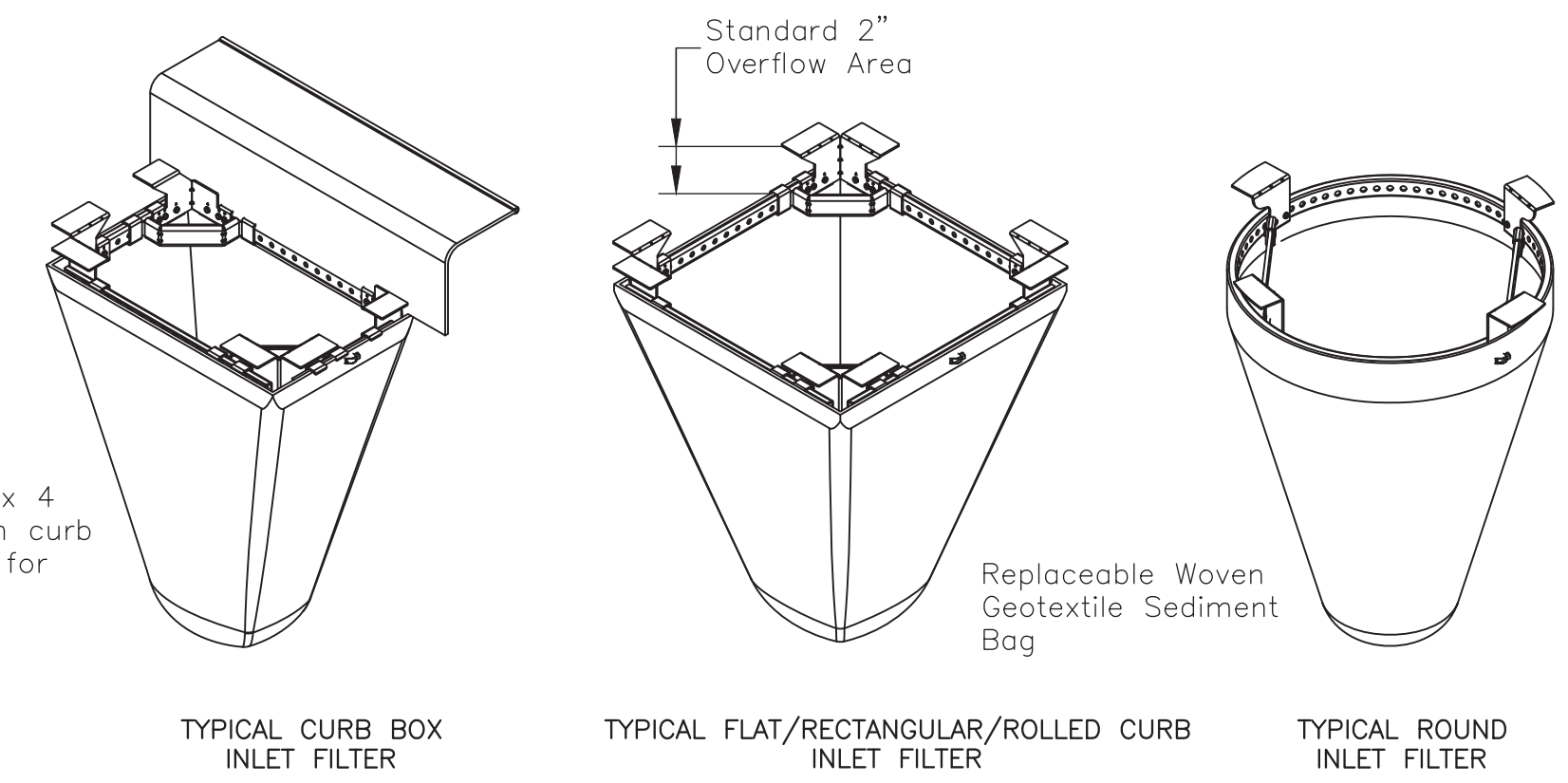

Note: Can slide 2 x 4 through flap if iron curb back not available for magnets.

- Materials:**
1. Framing - 11 gauge steel; corrosion resistant
 2. Sediment Bag - Woven Geotextile (Type FF or approved alternate); 2 cubic ft typical volume; Stainless Steel locking band securing bag to frame
- Installation:**
1. Remove grate
 2. Drop Inlet Filter onto load bearing lip of casting or concrete structure
 3. Replace grate

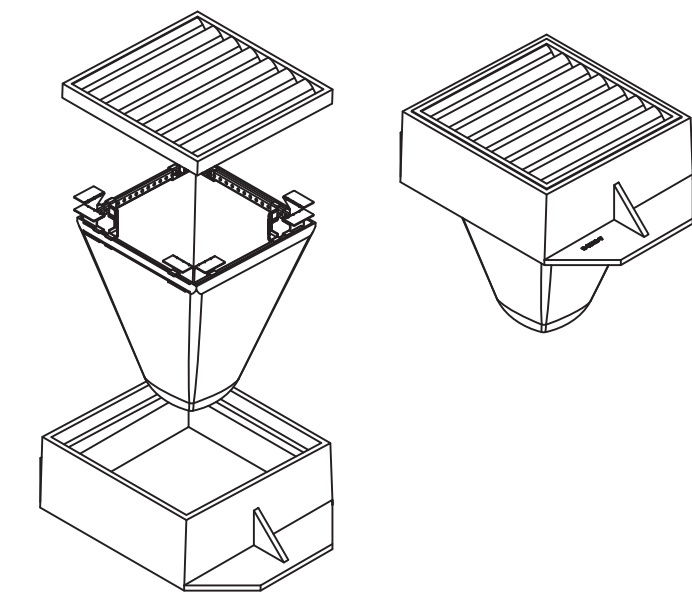

STORM DRAIN INLET PROTECTION

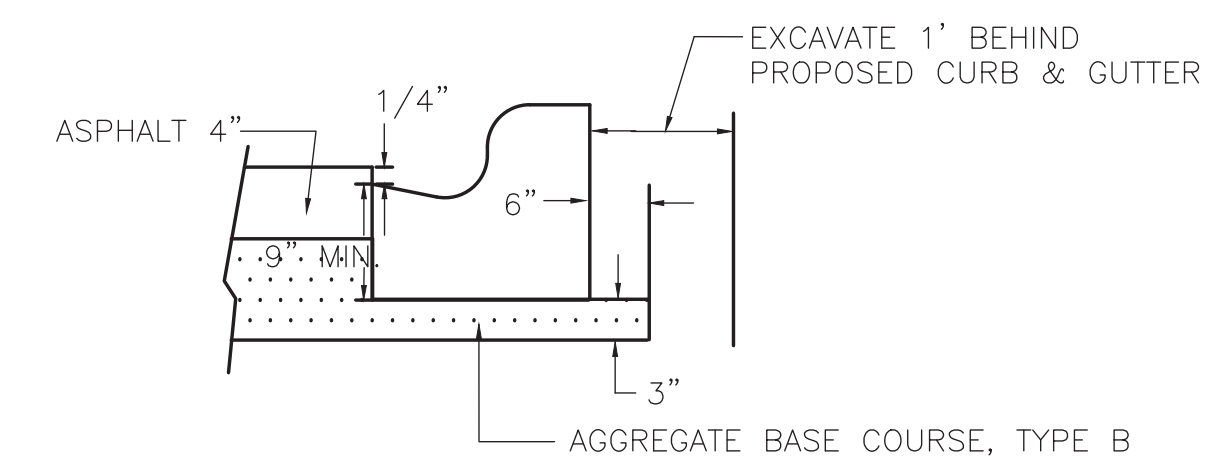

PROPOSED TYPICAL DETAIL
B.6-12 CURB

IDOT Highway Standards

000001-08	Standard Symbols, Abbreviations and Patterns
424001-11	Perpendicular Curb Ramps For Sidewalks
602011-02	Catchbasin Type C
602301-04	Inlet Type A
602401-07	Precast Manhole Type A
602701-02	Manhole Steps
604001-05	Frames & Lids Type 1
604051-04	Frame & Grate Type 11
606001-08	Conc. Curb T-B & Comb Curb & Gutter
701501-06	Urban Lane Closure, 2L, 2W, Undivided
701801-06	Sidewalk, Corner or Crosswalk Closure
701901-08	Traffic Control Devices
604056-04	Frame & Grate Type 11V

LEGEND

	PCC Sidewalk
	PCC Driveway, 6"
	PCC Driveway, 8"
	Full Depth Patching, 10.5" (1.5" Surface paid separately, 2.5" Binder, & 8" AGG Base)
	HMA DRIVEWAY PAVEMENT, 3" (1.5" Surface, 1.5" Binder)

2024 ROADWAY IMPROVEMENTS
Russell St (Clement - Highland)
General Notes & Legend

CHECKED BY: SM	SCALE: NONE
DESIGNED BY: DDO	DATE: 3/5/2024
DRAWN BY: DDO	SHEET 7 OF 7

DEPARTMENT OF PUBLIC WORKS
CITY OF JOLIET
150 W. JEFFERSON STREET, JOLIET, ILLINOIS 60431
(815)-724-4200

