

## Project Goals

- “Activate” this public space in the heart of Joliet
- Establish City Square as a hub for year-round events and a safe gathering space during all other times for local residents, employees, and students
- Support and promote downtown businesses and institutions
- Recognize and incorporate the historic significance of Downtown Joliet and make City Square a “must stop” for Route 66 travelers
- Showcase innovative design in landscaping, lighting, pavements, crosswalks, street furniture, public art, and signage
- Coordinate with and build upon the Chicago Street Reconstruction Project for a consistent design and safe place for all types of transportation
- Refine and advance the high level conceptual designs from the Chicago Street Corridor Plan (2018)

## Design Timeline



## We Want to Hear From You!

Provide any comments after the open house to the project team at [CitySquare@Joliet.gov](mailto:CitySquare@Joliet.gov)  
View all open house materials and sign up for project updates on the **project website: [Joliet.gov/CitySquare](http://Joliet.gov/CitySquare)**

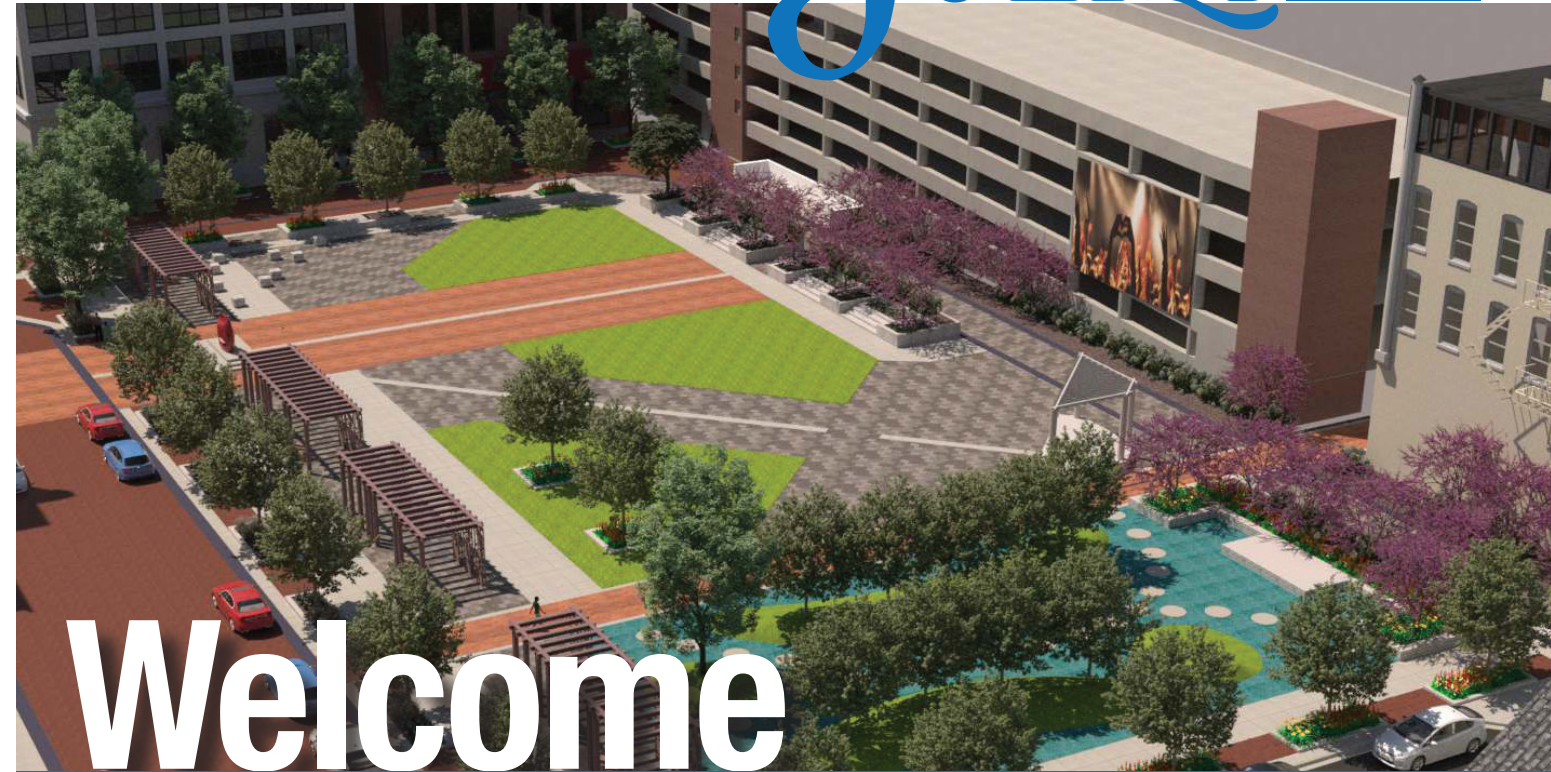

# Welcome

Thank you for attending the first Community Open House for the City Square Design. The City of Joliet recently began the detailed design of City Square and is excited to share initial concepts with the community and receive your feedback.

### At this open house, we welcome you to:

- View project boards presenting a project overview, two initial design concepts, design themes and design elements
- Discuss the project, ask questions, and provide your input to project team members stationed at the boards and throughout the room
- Provide your input through:
  - Discussions with the project team
  - Filling out a comment form
  - Placing red / green dots on features you do or do not like on the boards
  - Placing post-it notes on boards
  - Marking up a handout with the two initial design concepts
  - Emailing any comments to the project team at [CitySquare@Joliet.gov](mailto:CitySquare@Joliet.gov)

All open house materials are now posted on the project website. The public comment period for comments related to this open house will be open through March 17, 2023.

**Project Website: [Joliet.gov/CitySquare](http://Joliet.gov/CitySquare)**

## Design Concepts

City Square will bring a vibrant gathering place to Downtown Joliet. The Square will provide a “green oasis” in the city center, serve as an urban quad for students from nearby institutions and a place of respite for local employees and residents. It will also transform into an entertainment venue for local and regional events.

Both Design Concept 1 and Design Concept 2 include:

- **Open lawn:** Open lawn space provides a “village green” feeling and invites users to linger and spend more time in the space. Open lawn spaces are attractive for families — allowing informal space for play.
- **Planters with water features:** Water features provide a sense of cooling, movement and white noise that makes urban spaces feel more inviting and attractive.
- **Trees in planters:** Trees provide environmental benefits and can help address urban stormwater and flooding issues while providing shade and comfort to users. Building raised seatwalls and planter curbs around trees will help protect them from damage, while providing seating opportunities under their canopies.
- **Small, permanent stage:** A permanent stage serves as a focal point for the square, and can become an iconic feature that provides a sense of identity. It can be used for smaller day-to-day performances.
- **Space for larger, temporary stage:** A larger temporary stage is useful for special events that require heavier sound equipment, temporary lighting, more stage space and higher platform heights that would be more difficult to accommodate in a permanent design.
- **Custom seating:** Comfortable seating can help activate urban squares and encourage people to spend more time in the space. Students and professionals can use seating areas to work or study, and families can use seating while socializing.
- **Shade structures with bench seating below:** Shade structures provide an opportunity to frame the square and create a unique sense of place through custom architectural components that provide community identity.
- **Art components:** Art enhances a community’s identity and diversifies its cultural attractions. The inclusion of art can be a powerful way to connect the community to a space, and create a focal point for the square that will draw people in.
- **Space for temporary ice skating rink, holiday markets and a Christmas tree:** Seasonal activities activate the square and extend the usability of the space into the winter months.
- **Community identifiers:** The architectural style of an urban square can relate to the overall character of a community. Architectural elements that identify the space and convey a unique sense of place can help define the overall community character.
- **Paver flex streets:** A flexible street is a curbsless design that can accommodate many different uses, including special events and expanding business needs. Using pavers as a basis of the design creates a street that feels like an extension of the square, where pedestrian use is prioritized and vehicle speeds are reduced.
- **Flexible space for year-round activities, such as street festivals, food trucks, etc.:** Paver plaza and lawn space can be utilized for programmed events, which help to activate the space and make the downtown community a destination.

## Design Concept 1: Looking Northeast



**Design concept 1 maximizes the space** for events through additional open lawn and pavement. This concept provides greater flexibility for markets, small events, and daily open lawn play and seating.

## Design Concept 2: Looking Northeast



**Design concept 2 maximizes shade and seating** throughout the square, while still allowing for small and large events. This concept has an increased number of trees, planters, water features and shade structures.